



Philippine Electricity
Market Corporation

WESM COMPLIANCE BULLETIN

Issue No.	Date Issued	Contents
20.0	25-July-2023	Procedures and Guidelines for the Monitoring of the Look Ahead Submissions (LAS)

Enforcement and Compliance Office Philippine Electricity Market Corporation

25-July-2023

This Wholesale Electricity Spot Market (WESM) Compliance Bulletin is an occasional publication that is prepared and published by the Enforcement and Compliance Office of the Philippine Electricity Market Corporation. The purpose of the WESM Compliance Bulletin is only to provide information and guidance to the participants of the WESM on their obligations in the WESM as well as on various matters relating to enforcement and compliance. This document is not intended as a source of obligation or as authority on relevant WESM Rules and market manuals, and as such, is not binding on the WESM participants or any other person or entity. While the ECO strives to make this document complete and accurate, the actual contents may be incomplete or inaccurate. WESM participants and other readers are encouraged to refer to the official issuance of the WESM Rules, and its amendments and manuals for details.

Questions on this WESM Compliance Bulletin may be addressed to Enforcement and Compliance Office, Philippine Electricity Market Corporation, 18th Floor Robinsons Equitable Tower, ADB Avenue, Ortigas Center, Pasig City 1600 or by email at eco@wesm.ph

Contents

1.0	Introduction	3
2.0	Objectives	3
3.0	Coverage	4
4.0	Guidelines and Procedures	4
4.1	Parameters for Flagging.....	4
4.2	Monitoring and Flagging.....	5
4.3	Issuance of Look-Ahead Discrepancy Notices (LADN) and Response/s Thereto	6
4.4	Verification and Assessment	7
4.5	Reporting of Monitoring Results	7
5.0	Summary Table of Timeline.....	8
6.0	Enforcement Action	9
	Annex A - Submission of LAS Documents via FTP	9
	Annex B - Official List of Trading Participants and Plant Short Names	9

1.0 Introduction

In April 2023, the Department of Energy (DOE) directed the Philippine Electricity Market Corporation (PEMC) to establish, through its Enforcement and Compliance Office (ECO), the necessary parameters for implementing close monitoring of Day Ahead Projection (DAP) submissions by the WESM Generator-Trading Participants and imposing applicable enforcement actions in accordance with the market rules and manuals.

With the said directive, the ECO developed the parameters and procedures, as set out in this Bulletin, for monitoring the obligation of the WESM Generator-Trading Participants pertaining to their submission of the most recent self-scheduled nominations, bids, and offers¹ for all the relevant DAP runs, submitted through the Market Management System - Market Participant Interface (MMS-MPI). However, because of the extensive amount of data required for monitoring all DAP runs and the non-binding nature of day-ahead offers, the current monitoring approach is limited to the 1200H DAP Run. Hence, the ECO shall compare the day-ahead offers against the real-time offers by the generators for a specific DAP run, i.e., the 1200H DAP run, which is considered the most important DAP run as it is used by the SO for its reserve Contingency Planning.

The goal of this initiative or monitoring activity is to promote accurate market projections, such as the DAP that would –

- Assist stakeholders in making informed trading decisions.
- Aid the Market Operator in its demand forecasting.
- Aid the System Operator in carrying out its reserve contingency planning.
- Enable early grid alert notices and intensify the Interruptible Load Program (ILP) implementation.
- Assist ILP providers in preparing their respective generator sets and business process adjustments in case of a supply deficiency.

The said monitoring activity will require coordination and the submission of explanations from WESM Generator-Trading Participants who have been flagged for possible noncompliance with the obligation to submit their most recent day-ahead offers or nominations in comparison to their real-time offers.

The parameters for flagging discrepancies between day-ahead offers and real-time offers, as well as the procedures for issuing notice and providing explanations (enforcement proceedings), were presented to the DOE and discussed with WESM Generator-Trading Participants (during a focus group discussion held in July 2023). The ECO may, however, amend and improve the flagging parameters specified in this bulletin as deemed necessary.

2.0 Objectives

For the WESM Participants:

- To be oriented about the Look Ahead Submissions (LAS) monitoring procedures
- To be guided on the types of documents and forms that may be submitted to ECO
- To be guided on how to access the LAS Flagging
- To be guided on how to accomplish and submit the necessary forms relating to LAS monitoring

¹ Based on Table 2 of Section 4.4 of the WESM Timetable, WESM Dispatch Protocol Manual 18.0

3.0 Coverage

This weekly LAS monitoring covers:

1. Scheduled and Self-Scheduled Generating Units
2. Plants with Final Certificate of Approval to Connect (FCATC) in accordance with the provisions of DOE Department Circular DC 2022-05-0015².

4.0 Guidelines and Procedures

This section defines the parameters for flagging discrepancies between *DAP Offers* and *RTD Offers*. It also outlines the procedures for notifying WESM Generator-Trading Participants using a Look-Ahead Discrepancy Notice (LADN) form and how they can submit the accomplished form to ECO for assessment of their justifications or reasons.

It must be noted, however, that discrepancies between the *DAP Offers* and the *RTD Offers* do not necessarily and conclusively mean that the TP fails to provide accurate information to the Market Operator and the System Operator via the market management system with respect to their nominations or offers. It is important that the reason(s) for any discrepancy be obtained from the concerned TPs in order to determine if inaccuracies in the offer submissions are violative of the rules relating to dispatch and scheduling.

4.1 Parameters for Flagging

The following will be checked by ECO daily:

- **DAP Offer** – day-ahead MW Offer/Nomination submitted by the TP that was used for the 1200H Day-Ahead Projection (DAP) run.
- **RTD Offer** – real-time MW Offer/Nomination submitted by the TP that was used in the generation of its real-time dispatch schedules. It is the MW Offer value of the last 5-minute interval of the relevant trading hour (top-of-the-hour).
- **MW Discrepancy** - difference between the day-ahead offer and real-time offer computed by subtracting the *RTD Offer* from the *DAP Offer*. $MW\ Discrepancy = RTD\ Offer - DAP\ Offer$
- **Percent (%) Discrepancy** - the equivalent percentage discrepancy between the day-ahead offer and real-time offer determined by dividing the *RTD Offer* by the *DAP Offer*, then subtracting to 100%. $\% Discrepancy = (RTD\ Offer / DAP\ Offer) - 1$
- **Effective Discrepancy** - average hourly discrepancy in MW and in percentage.
- **Absolute Discrepancy** - MW Summation of the Discrepancy in Absolute Values.
- **Frequency** - number of flagged hourly intervals.
- **Trend** - *RTD Offer* and *DAP Offer* patterns.
- **Positive Discrepancy** - MW summation of intervals where the *RTD Offer* is greater than the *DAP Offer*
- **Negative Discrepancy** - MW summation intervals where the *RTD Offer* is less than the *DAP Offer*

² Supplementing Department Circular No. DC2021-06-0013 on the Framework Governing the Test and Commissioning of Generation Facilities for Ensuring Readiness to Deliver Energy to the Grid or Distribution Network, published on the DOE Website in June 2022.

- **Look Ahead Flagging** - result of the LAS monitoring. Flagged generating units due to discrepancies between its DAP Offer and RTD Offer based on parameters set by the ECO.

4.2 Monitoring and Flagging

- ECO shall monitor daily the *DAP offer vis-a-vis the RTD Offer, frequency* of flagging and *trend* of the Trading Participants. It must be able to come up with the Look-Ahead Discrepancy Notices (LADN) based on the following metrics –

a) Discrepancy

Discrepancy will be determined by getting the difference of RTD Offer and DAP Offer.

Discrepancy flagging tolerances will be +/- 13% *Percent Discrepancy* or +/- 2 *MW Discrepancy*³, whichever is higher. Eighty percent (80%) of the time, according to ECO's study (of LAS data from May to June 2023), participants tend to reside within these discrepancies. TPs having discrepancy between their DAP offers and their RTD offers beyond these tolerances shall be flagged but with consideration to *frequency*.

b) Frequency

Frequency will be based on the number of flaggings that the discrepancy occurred. It shall be equivalent of three (3) days or 72 hours each week before it can qualify as flagging that need to be covered by LADN.

c) Trend

ECO shall also conduct monitoring through manual/visual observation of patterns and/or behavior of the generators with respect to their *DAP Offers* and/or *RTD Offers*. This is independent of the assessment based on *discrepancy* and *frequency*.

Note: For example, a facility demonstrates a consistent failure to update its day-ahead offers to align with its real-time offers, even if the level of discrepancy is within the tolerances, the facility will be issued an LADN because of a *non-updating trend*.

In the same manner, even if a facility's day-ahead offer tends to deviate only on a particular hour in a day during the monitored week, the facility will be issued a LADN to explain, *regardless of the level and frequency, it deviates on the same hour*.

This shall, however, apply on a case-by-case basis and is not limited to the aforementioned examples.

- The ECO may conduct its initial assessment through calls/text messaging/meeting/conference to gather advance information on the reasons for the flagged probable breach of DAP monitoring.

³ The discrepancy parameter may be subject to change, as deemed necessary.

4.3 Issuance of Look-Ahead Discrepancy Notices (LADN) and Response/s Thereto

The following procedures pertain to filling out or accomplishing the Look-Ahead Discrepancy Notice (LADN):

- The ECO shall transmit the LADN to the concerned Trading Participants (TP) every Tuesday following the covered week monitored.
- The TP shall indicate in the LADN the reason or event which caused the *discrepancy* and the exact time and time of the occurrence of such event.
- A system generated email will be issued simultaneously after the successful transmittal of the notice through the Secured File Transfer Protocol (SFTP).
- The TP must be able to submit the accomplished LADN specifically indicating the explanation of the DAP Offer and RTD Offer discrepancy substantiated by supporting documents, if necessary.
- The following provides the description and conditions in accomplishing the documents and forms to be submitted to ECO:

Document/ Form	Description	Conditions
Look-Ahead Discrepancy Notice (LADN)	Form that contains the list of all flagged intervals for one week for a particular facility or resource as well as the guide questions to determine the basis for <i>DAP offers</i> and reason(s) for discrepancy with the <i>RTD offers</i> .	1) The trading participant shall download the LADN in the SFTP and select the appropriate reason and provide additional explanations for all the flagged intervals.
Supporting Documents (SD)	These refer to electronic copies of plant operator records, correspondences and relevant data or information that show proof or evidence that external factors have affected the plant's ability to provide accurate information to the Market Operator and the System Operator via the market management system with respect to their nominations or offers.	1) Supporting documents must be compressed in zip/rar files together with the accomplished LADN. 2) The accomplished LADN and SDs in zip/rar files shall be sent via a secure file transfer protocol (FTP) facility. (See attached Annex B for the related Work Instruction)

4.4 Verification and Assessment

- Based on the accomplished LADN submitted and received in accordance with Section 4.2 of this Guidelines, the ECO shall validate and verify the explanations and supporting documents. It may also verify or validate some data with IEMOP or the System Operator if necessary.
- After due verification and assessment, the ECO shall make a conclusion on the reason or explanation for the flagged intervals between the TPs' DAP and RTD Offers and provide a copy of its result to the TP monthly through the Compliance Monitoring and Assessment Report – Look Ahead Submission (CMAR-LAS).

4.5 Reporting of Monitoring Results

- The ECO shall also report to the DOE the weekly result of DAP monitoring for information and appropriate action.
- The following provides the description and conditions for the reports to be issued by ECO:

Document/ Form	Description	Conditions
Look-Ahead Discrepancy Weekly Report (Tableau Dashboard)	Report that contains the result of ECO's monitoring of the participants' DAP and RTD Offers.	To be submitted to the DOE for its information and other actions necessary for the effective implementation of the Interruptible Load Program
Compliance Monitoring and Assessment Report – Look Ahead Submission (CMAR- LAS)	Report that contains the individual results of ECO's assessment of all flagged intervals for one billing period for a particular facility or resource.	The ECO shall make a conclusion on the justification and/or explanations for the discrepancy provided by the TP.

5.0 Summary Table of Timeline

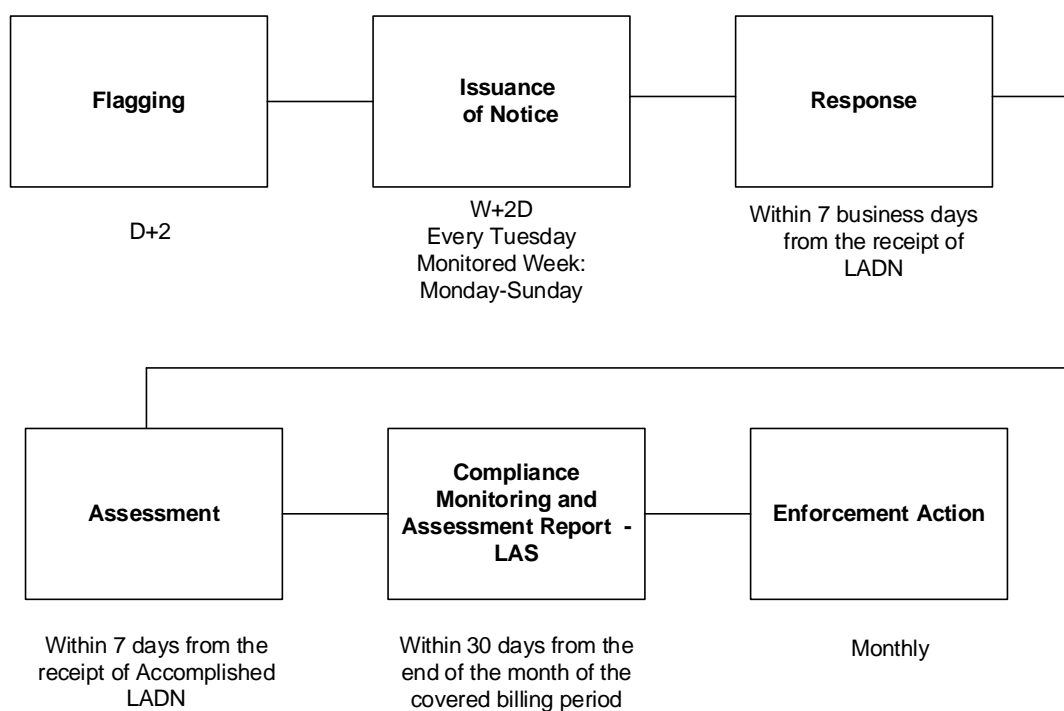

Process	Report/Forms	Platform/Tool	Timeline
Issuance of the Look-Ahead Discrepancy Notice (LADN)	Look-Ahead Discrepancy Notice (LADN)	FTP	Every Tuesday following the covered week monitored
Validation and Submission of explanation by TP	Accomplished Look-Ahead Discrepancy Notice (LADN)	FTP	Within seven (7) business days from the receipt of LADN
Validation by ECO	Accomplished Look-Ahead Discrepancy Notice (LADN) and Supporting Documents	FTP	Within seven (7) business days from the receipt of accomplished LADN
Weekly Reporting	Look-Ahead Discrepancy Weekly Report	EMAIL/Tableau	Within fifteen (15) business days from the issuance of LADN
Issuance of the Compliance Monitoring and Assessment Report – Look Ahead Submission (CMAR-LAS).	Compliance Monitoring and Assessment Report – Look Ahead Submission (CMAR-LAS).	EMAIL/FTP	Thirty (30) business days from the end of the calendar month of the covered monitoring period

6.0 Enforcement Action

This refers to the action that needs to be implemented after due assessment or after finding the TP in breach of the WESM Rules with respect to revision of offers / nominations, especially when its act or omission appears to be prejudicial to the market and might affect the efficiency of the market or the decision-making of the Market Operator, the System Operator, the ILP providers, and other stakeholders.

If there is a finding of breach, ECO will implement the following:

Phase	Enforcement Action	Timeline
Phase 1	Imposition of Remedial Measures	3Q 2023 (Jul-Sept 2023)
Phase 2	Imposition of Remedial Measures Initiation of Motu Proprio Investigation / Imposition of Sanctions, as may be authorized under the WESM Penalty Manual.	4Q 2023 and onwards

Annex A - Submission of LAS Documents via FTP

Annex B - Official List of Trading Participants and Plant Short Names

Annex A – Submission of LAS Documents via FTP

PEMC WORK INSTRUCTIONS FOR SUBMISSION OF LAS DOCUMENTS VIA FTP

For this issue of the Work Instruction, the Trading Participant will be guided on the following:

- Documents and forms to be submitted to Enforcement and Compliance Office (ECO)
- Facility for the submission of reply and documents
- Procedure for uploading of files
- Additional or revision of reports submitted

1. Documents

There are two types of documents that will be used on the monitoring:

- a. Inbound Documents (Look-Ahead Discrepancy Notice)
- b. Outbound Documents (Inbound to PEMC-ECO)

Table 1. 0 Document Types

TYPE	DESCRIPTION	SENDER	FORM TO BE USED
CPEMS Documents			
Look-Ahead Discrepancy Notice	Form that contains the list of all flagged intervals for one week for a particular facility or resource.	ECO	Look-Ahead Discrepancy Notice
Outbound Documents			
Accomplished Look-Ahead Discrepancy Notice (ALADN)	A response or reply supported or substantiated by relevant documents to prove that a significant event/reason for a specific interval has caused the forecast error.	Trading Participants	Look-Ahead Discrepancy Notice
Supporting Documents (SD)	These refer to electronic copies of plant operator records, correspondences and relevant data or information that will show proof or evidence that external factors have affected the plant's performance, and which led to a forecast error.	Trading Participants	Any relevant and available supporting documents <i>(These can be zipped or compressed with the Accomplished Form)</i>

2. Document Format and Filename

The documents shall be submitted in electronic files in the following format:

Table 2.0 Format and Filename

Document	Filename		File Format
	Naming Convention	Example	
Accomplished Look-Ahead Discrepancy Notice	LADN_TPSHORTNAME_ PLANTSHORTNAME_YYYY_ WK#	LADN_MPGCGEN_MPGC _2023_WK29	ALADN and SD - zip/rar

*Note: For the **official** short names, i.e., Trading Participant and Plant **Short Names**, please refer to **Annex B***

3. Schedule of Submissions

The documents shall be submitted within the timeline set below:

Table 3.0 Schedule of Submissions

Document	Responsible	Deadline	Example
Look-Ahead Discrepancy Notice (LADN)	PEMC-ECO	Every Tuesday	<ul style="list-style-type: none"> July 17-23, 2023 (Monday to Sunday) Week 29 Release – July 25, 2023 (Tuesday)
Document	Responsible	Deadline	Example
Accomplished LADN and SD	Trading Participant	7 business days from the from the receipt of LADN	<ul style="list-style-type: none"> July 25, 2023 - LADN <p>Submission of reply and documents – August 1, 2023</p>
Additional SD	Trading Participant	10 business days from the from the receipt of LADN	<ul style="list-style-type: none"> July 25, 2023 - LADN <p>Submission of reply and documents – August 4, 2023</p>

4. Facility for the Retrieval and Submission of Documents

The documents shall be retrieved and submitted through PEMC-Secured File Transfer Protocol (SFTP) website:

For Retrieval of LADN: <https://ftp-out.wesm.ph/login>

For Submission of ALADN: <https://ftp-in.wesm.ph/login>

5. Log-in Credentials

- Log-in credentials (username and password) are assigned to each Trading Participant.
- For further assistance in account creation and password reset, please get in touch with PEMC-ECO at eco@wesm.ph or eco-cmd@wesm.ph

6. Procedure for Retrieving Files

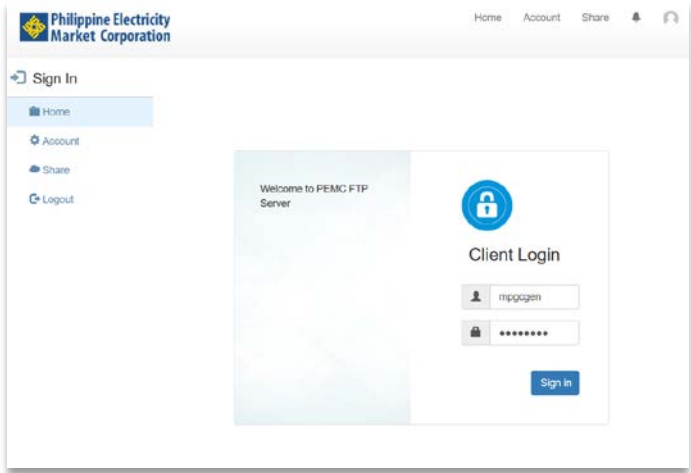
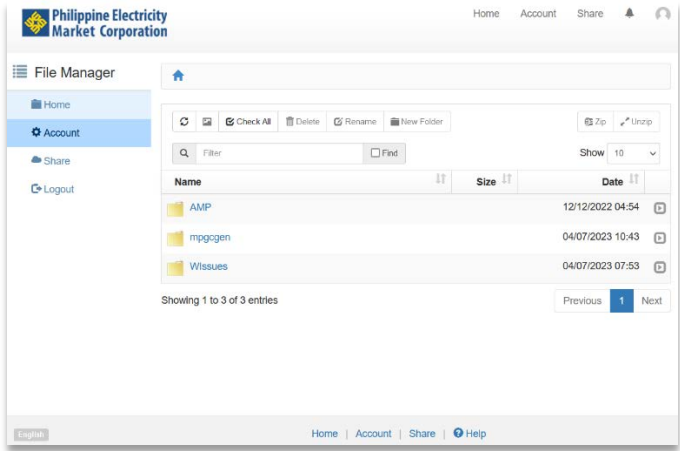
Steps	Screenshot
<p>Log in to PEMC FTP website at https://ftp-out.wesm.ph/login</p> <p>Log-in credentials (username and password) are assigned for each WESM Trading Participant. These details will be provided upon request. For further assistance, please get in touch with the PEMC-ECO.</p>	
<p>Upon successful login, the main window will be displayed.</p> <p>Under the username folder, the trading participants shall be able to view and download the LADN from PEMC-ECO.</p>	

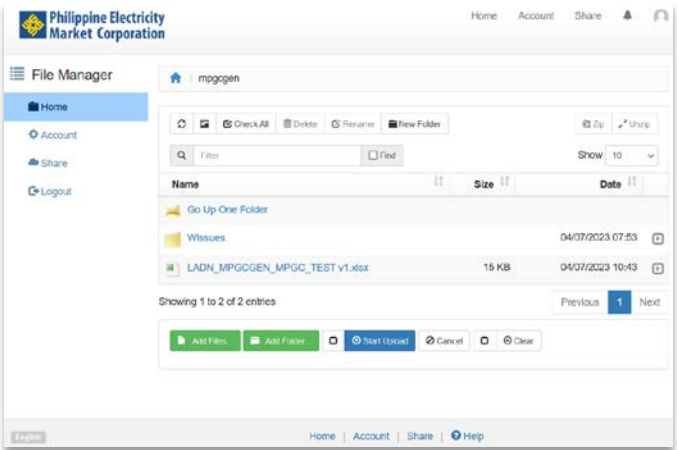
	
--	--

7. Procedure for Uploading Files

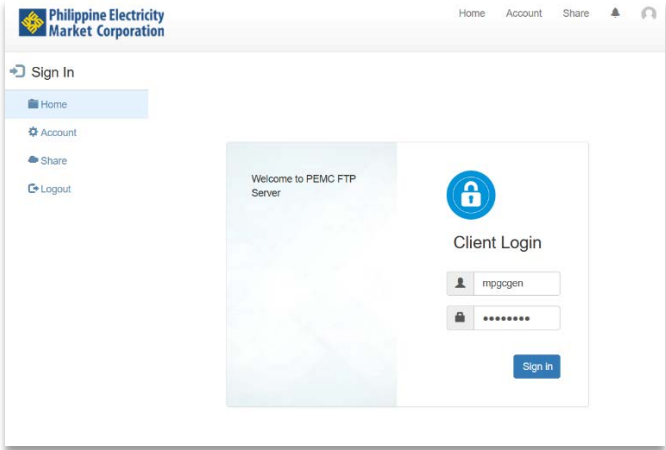
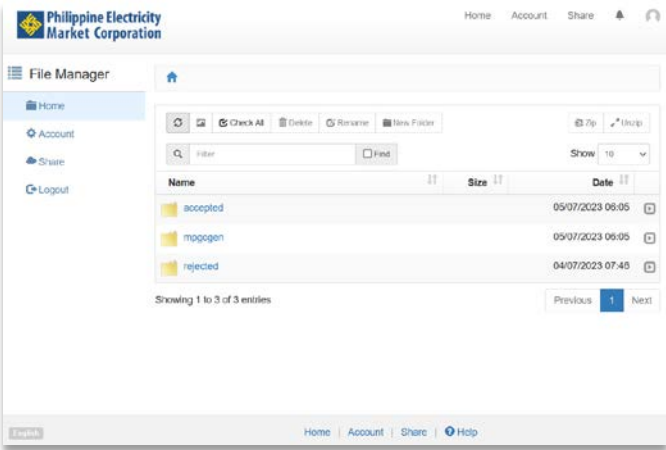
Steps	Screenshot
<p>Log in to PEMC FTP website at https://ftp-in.wesm.ph/login.</p> <p>Log-in credentials (username and password) are assigned for each WESM Trading Participant. These details will be provided upon request. For further assistance, please get in touch with the PEMC-ECO.</p>	
<p>Upon successful login, the main window will be displayed.</p> <p>The main window contains three folders, as follows –</p> <ul style="list-style-type: none"> Accepted – which contains all successfully uploaded files. Rejected – which contains files with incorrect filename format Username Folder (ex. mpgcgen) - this is where the files will be uploaded/ This folder should be empty at all times. 	
<p>To upload a file, select the Username folder and then click</p>	

the “Add files” button or use the “Drag and Drop” option.

The Drag & Drop upload feature is also available on other browsers (e.g Mozilla Firefox, Google Chrome)

Once the file(s) to be submitted has been added, click the Start button to start uploading the file/s.

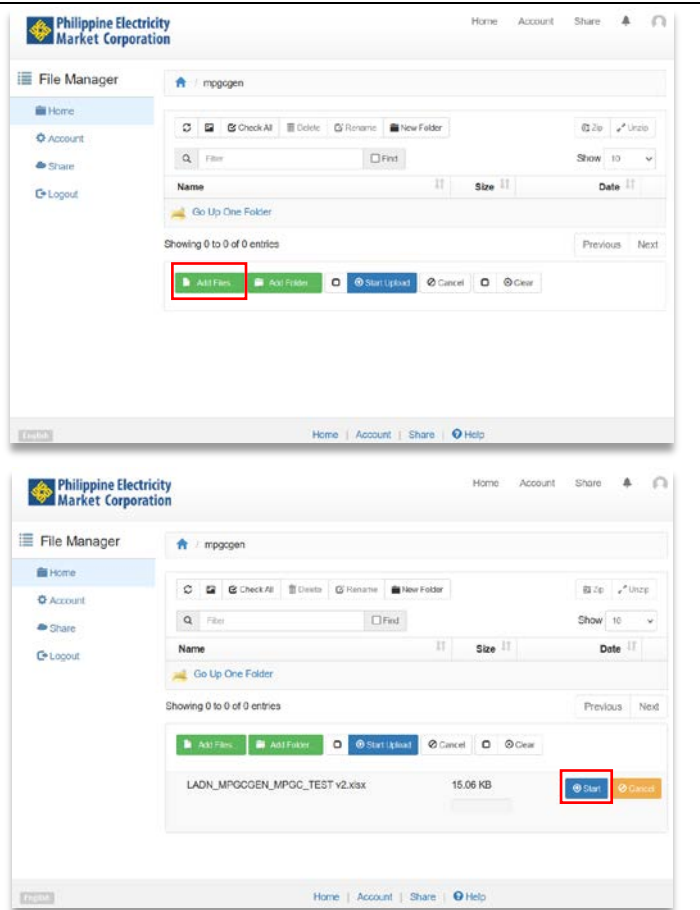

8. Addition or Revision of Submissions

- The Trading Participant may submit additional supporting documents to support the new or revised information.
- Any documents submitted to ECO may be revised within the timeline referred to in Section 3 of this document, if there are corrections, amendments, or additional information that need to be made.
- The additional or revised document shall be submitted in the same manner described in Section 7.
- The filename shall indicate that it is revised by adding a suffix “Rev”.

Annex B – Official List of Trading Participants and Plant Short Names
As of 25 July 2023

Market Participant Name	Market Trading Node	USERNAMES FTP	Plant Shortname (Per ECO)	LAS Cluster (Per ECO)
1590 Energy Corporation	01BAUANG_GS1	1590ECGEN	BAUANG	Super
1590 Energy Corporation	01BAUANG_GS2	1590ECGEN	BAUANG	Super
1590 Energy Corporation	01BAUANG_GS3	1590ECGEN	BAUANG	Super
Absolut Distillers Inc.	03ADISOL_G01	ABSOLUTDIGEN	ADISOL	CF
AC Energy Philippines, Inc.	08STBAR_PB2	PHENGEN	STBAR	Super
AC Energy Philippines, Inc.	05PHNPB3_G01	PHENGEN	PHNPB3	Super
Alternergy Wind One Corporation	03AWOC_G01	AWOC	AWOC	CF
Alterpower Digos Solar, Inc.	13DIGSOL_G01	APDIGOSGEN	DIGSOL	Carl
Amlan Hydroelectric Power Corporation	06AMLA_G01	AMLANHPCGEN	AMLA	Carl
Anda Power Corporation	01ANDA_G01	ANDAGEN	ANDA	Super
Angat Hydropower Corporation	01ANGAT_A	AHCGEN	ANGAT	Super
Angat Hydropower Corporation	01ANGAT_M	AHCGEN	ANGAT	Super
AP Renewables Inc.	03MKBN_A	APRIGEN	MKBN	CF
AP Renewables Inc.	03MKBN_B	APRIGEN	MKBN	CF
AP Renewables Inc.	03MKBN_C	APRIGEN	MKBN	CF
AP Renewables Inc.	03MKBN_D	APRIGEN	MKBN	CF
AP Renewables Inc.	03MKBN_E	APRIGEN	MKBN	CF
AP Renewables Inc.	03ORMAT_G01	APRIGEN	ORMAT	Super
AP Renewables Inc.	03TIWI_A	APRIGEN	TIWI	Super
AP Renewables Inc.	03TIWI_C	APRIGEN	TIWI	Super
Asia Pacific Energy Corporation	01APEC_G01	APECGEN	APEC	Super
Asian Carbon Neutral Power Corp.	01ACNPC_G01	ACNPCGEN	ACNPC	CF
Asian Greenenergy Corp	11KBSOL_G01	AGECOGEN	KBSOL	CF
Asiga Green Energy Corp.	12ASIGA_G01	ASIGAGEN	ASIGA	CF
Astronergy Development Gensan Inc.	14ASTROSOL_G01	ADGIGEN	ASTROSOL	Super
Bac-Man Geothermal Inc.	03BACMAN_U01	BGIGEN	BACMAN	Carl
Bac-Man Geothermal Inc.	03BACMAN_U02	BGIGEN	BACMAN	Carl
Bac-Man Geothermal Inc.	03BACMAN_U03	BGIGEN	BACMAN	Carl
Bataan 2020 Power Ventures, Inc.	01BT2020_G01	BTN2020GEN	BT2020	Carl
Bataan 2020, Inc.	01BT2020_G02	BTN2020GENB	BT2020B	Super
Bataan Solar Energy Inc.	01BTSOLEN_G01	BSEIGEN	BTSOLEN	Carl
Bataan Solar Energy Inc.	01BTSOLEN_BAT	BSEIGEN	BTSOLEN	Carl
Bayog Wind Power Corp.	01BALWIND_G01	BWPCGEN	BALWIND	CF
BEHMC Lower Labayat Hydropower Corp.	03LWERLAB_G01	BEHMCLLHC	LWERLAB	CF
Belgrove Power Corporation	03MALAYA_G02	BPCGEN	MALAYA2	Super
Bicol Biomass Energy Corporation	03BBEC_G01	BBECGEN	BBEC	Carl
Bicol Hydropower Corporation	03INARI_G01	BHCGEN	INARI	CF
Biotech Farms, Inc.	14BIOMS_U01	BFIGEN	BIOMS	CF
Biotech Farms, Inc.	14BIOGS_G01	BFIGEN	BIOGS	CF
Biscom, Inc.	06BISCOM_G01	BISCOMGEN	BISCOM	Carl
BOHECO I Sevilla Mini Hydro Corp.	07SEVILL_G01	BSMHCGEN	SEVILL	Carl
Bohol I Electric Cooperative, Inc.	07JANOPO_G01	JANOPOLGEN	JANOPO	Super

Bosung Solartec, Inc.	01BOSUNG_G01	BOSUNGEN	BOSUNG	CF
Bubunawan Power Company, Inc.	11MINBU_G01	BUBUNAWAGEN	MINBU	CF
Bulacan Power Generation Corporation	01T_ASIA_G01	TAPGCGEN	T-ASIA	Super
Citicore Solar Bulacan, Inc.	01BULSOL_G01	BULACNSEGEN	BULSOL	Super
Cagayan Biomass Energy Corporation	01CAGBIO_G01	CBECGEN	CAGBIO	Super
Cebu Energy Development Corporation	05CEDC_U01	CEDCGEN	CEDC	Carl
Cebu Energy Development Corporation	05CEDC_U02	CEDCGEN	CEDC	Carl
Cebu Energy Development Corporation	05CEDC_U03	CEDCGEN	CEDC	Carl
Cebu Private Power Corporation	05CPPC_U01	CPPCGEN	CPPC	Carl
Cebu Private Power Corporation	05CPPC_U02	CPPCGEN	CPPC	Carl
Cebu Private Power Corporation	05CPPC_U03	CPPCGEN	CPPC	Carl
Cebu Private Power Corporation	05CPPC_U04	CPPCGEN	CPPC	Carl
Cebu Private Power Corporation	05CPPC_U05	CPPCGEN	CPPC	Carl
Cebu Private Power Corporation	05CPPC_U06	CPPCGEN	CPPC	Carl
Cebu Private Power Corporation	05CPPC_U07	CPPCGEN	CPPC	Carl
Cebu Private Power Corporation	05CPPC_U08	CPPCGEN	CPPC	Carl
Cebu Private Power Corporation	05CPPC_U09	CPPCGEN	CPPC	Carl
Cebu Private Power Corporation	05CPPC_U10	CPPCGEN	CPPC	Carl
Central Azucarera de Bais, Inc.	06CABI_G01	CABGEN	CABI	Carl
Central Azucarera de San Antonio	08CASA_G01	CASAGEN	CASA	Super
Central Azucarera Don Pedro, Inc.	03CADPI_G01	CADPIGEN	CADPI	CF
Central Negros Power Reliability, Inc.	06CENPRI_U02	CENPRIGEN	CENPRI	CF
Central Negros Power Reliability, Inc.	06CENPRI_U01	CENPRIGEN	CENPRI	CF
Central Negros Power Reliability, Inc.	06CENPRI_U03	CENPRIGEN	CENPRI	CF
Central Negros Power Reliability, Inc.	06CENPRI_U04	CENPRIGEN	CENPRI	CF
Central Negros Power Reliability, Inc.	06CENPRI_U05	CENPRIGEN	CENPRI	CF
CIP II Power Corporation	01CIP2_G01	CIP2GEN	CIP2	Carl
Cleangreen Energy Corporation	01CLEANG_G01	CECGEN	CLEANG	Super
Cosmo Solar Energy, Inc.	08COSMO_G01	CSEIGEN	COSMO	CF
East Asia Utilities Corporation	05EAUC_U01	EAUCGEN	EAUC	Super
East Asia Utilities Corporation	05EAUC_U02	EAUCGEN	EAUC	Super
East Asia Utilities Corporation	05EAUC_U03	EAUCGEN	EAUC	Super
East Asia Utilities Corporation	05EAUC_U04	EAUCGEN	EAUC	Super
Ecopark Energy of Valenzuela Corp.	02ECOPRK_G01	ECOPARKGEN	ECOPRK	CF
Ecopark Energy of Valenzuela Corp.	02ECOTAGA_G01	ECOPARKGEN	ECOPRK	CF
EDC Burgos Wind Power Corporation	01BURGOS_G01	EBWPCGEN	BURGOSW	Carl
Energy Development Corporation	06NASULO_G01	EDCGEN	NASULO	Carl
Energy Development Corporation	01BURGOS_G02	EDCSL	BURGOS	Carl
Energy Development Corporation	14MTAPO_U01	EDCGEN	MTAPO1	Super
Energy Development Corporation	14MTAPO_U03	EDCGEN	MTAPO1	Super
Energy Development Corporation	01BURGOS_G03	EDCSL	BURGOS	Carl
Energy Logics Philippines, Inc.	01PASQSOL_G01	ELPISPPGEN	PASQSOL	CF
Enfinity Philippines Renewable Resources Inc.	01CLASOL_G01	ENFINITYGEN	CLASOL	Super
Euro Hydro Power (Asia) Holdings, Inc.	13EUROH_G01	EUROHYDROGEN	EUROH	Super
Euro Hydro Power (Asia) Holdings, Inc.	14MARBEL_U01	EUROHYDROGEN	MARBEL	Super
Euro Hydro Power (Asia) Holdings, Inc.	14ALMADA_G01	EUROHYDROGEN	ALMADA	Super

FDC Misamis Power Corporation	11FDC_U01	FDCGEN	FDC	Super
FDC Misamis Power Corporation	11FDC_U02	FDCGEN	FDC	Super
FDC Misamis Power Corporation	11FDC_U03	FDCGEN	FDC	Super
FG Bukidnon Power Corporation	11FGBPC_G01	FGBPCGEN	FGBPC	CF
FGP Corporation (San Lorenzo)	03STA-RI_G05	FGPSNLOGEN	SANLO	CF
FGP Corporation (San Lorenzo)	03STA-RI_G06	FGPSNLOGEN	SANLO	CF
First Cabanatuan Renewable Ventures Inc.	01CABSOL_G01	FCRVGEN	CABSOL	CF
First Farmers Holdings Corporation	06FFHC_G01	FFHCGEN	FFHC	Super
First Gas Power Corporation (Sta Rita)	03STA-RI_G01	FGPSTARIGEN	STA-RI	Super
First Gas Power Corporation (Sta Rita)	03STA-RI_G02	FGPSTARIGEN	STA-RI	Super
First Gas Power Corporation (Sta Rita)	03STA-RI_G03	FGPSTARIGEN	STA-RI	Super
First Gas Power Corporation (Sta Rita)	03STA-RI_G04	FGPSTARIGEN	STA-RI	Super
First Gen Hydro Power Corporation	01MASIWA_G01	FGHPCGEN	MASIWA	Super
First Gen Hydro Power Corporation	01PNTBNG_U01	FGHPCGEN	PNTBNG	Super
First Gen Hydro Power Corporation	01PNTBNG_U02	FGHPCGEN	PNTBNG	Super
First Natgas Power Corporation	03SNGAB_G01	FNPCGEN	SNGAB	CF
First Solar Energy Corp.	04PHSOL_G01	FSOLEQGEN	PHSOL	Super
Citicore Solar Cebu, Inc.	05TOLSOL_G01	FTOLEDOGEN	TOLSOL	Carl
GIGA ACE 4, Inc.	03ALMNOS_BAT1	GIGAACE4GEN	ALMNOS	Carl
GIGA ACE 4, Inc.	03ALMNOS_BAT2	GIGAACE4GEN	ALMNOS	Carl
GIGASOL3, Inc.	01GIGSOL_G01	GIGASOL3GEN	GIGSOL	Carl
GN Power Kauswagan Ltd. Co.	10GNPK_U01	GNPKLCOGEN	GNPK	Super
GN Power Kauswagan Ltd. Co.	10GNPK_U02	GNPKLCOGEN	GNPK	Super
GN Power Kauswagan Ltd. Co.	10GNPK_U03	GNPKLCOGEN	GNPK	Super
GN Power Kauswagan Ltd. Co.	10GNPK_U04	GNPKLCOGEN	GNPK	Super
GNPower Dinginin Ltd. Co.	01GNPD_U01	GNPDGEN	GNPD	Carl
GNPower Dinginin Ltd. Co.	01GNPD_U02	GNPDGEN	GNPD	Carl
GNPower Mariveles Energy Center Ltd. Co.	01MARVEL_G01	GMCPGEN	MARVEL	CF
GNPower Mariveles Energy Center Ltd. Co.	01MARVEL_G02	GMCPGEN	MARVEL	CF
Grassgold Renewable Energy Corporation	01GRGOLD_G01	G2RECGEN	GRGOLD	Carl
Green Core Geothermal Inc.	06PAL1A_G01	GCGIGEN	PAL1A	Super
Green Core Geothermal Inc.	06PAL2A_U01	GCGIGEN	PAL2A	Super
Green Core Geothermal Inc.	06PAL2A_U02	GCGIGEN	PAL2A	Super
Green Core Geothermal Inc.	06PAL2A_U03	GCGIGEN	PAL2A	Super
Green Core Geothermal Inc.	06PAL2A_U04	GCGIGEN	PAL2A	Super
Green Core Geothermal Inc.	04LGPP_G01	GCGIGEN	LGPP	Carl
Greencore Power Solutions 3, Inc.	01ARAYSOL_G01	GPS3IGEN	ARAYSOL	Carl
Greencore Power Solutions 3, Inc.	01ARAYSOL_G02	GPS3IGEN	ARAYSOL	Carl
Green Earth Enersource Corporation	14GERBIO_G01	GREENEECGEN	GERBIO	CF
Green Future Innovations, Inc.	01GFII_G01	GFIIGEN	GFII	Carl
Green Innovations for Tomorrow Corporation	01GIFT_G01	GIFTGEN	GIFT	Carl
Green Innovations for Tomorrow Corporation	01GIFT_G02	GIFTGEN	GIFTNS	Carl
GT-Energy Corp.	04CLBYBNK_G01	GTECGEN	CLBYBNK	CF
Guimaras Wind Corporation	08SLWIND_G01	PHINMAREGEN	SLWIND	Super

Hawaiian-Philippine Company	06HPCO_G01	HPCOGEN	HPCO	CF
Hawaiian-Philippine Company	06HPCO_G02	HPCOGEN	HPCO	CF
Hedcor Bukidnon, Inc.	11MANFOR_G01	HEDBUKGEN	MANFOR	CF
Hedcor Bukidnon, Inc.	11MANFOR_G02	HEDBUKGEN	MANFOR	CF
Hedcor Sabangan, Inc.	01SABANG_G01	HSABIGEN	SABANG	Carl
Hedcor Sibulan, Inc.	13SIBULAN_G01	SIBULANGEN	SIBULAN	Carl
Hedcor Tudaya, Inc. - Tudaya II	13TUDAY2_G01	HTI2GEN	TUDAY2	Carl
HEDCOR, Inc.	01SLANGN_G01	HEDCORGEN	SLANGN	Carl
HEDCOR, Inc.	01NMHC_G03	HEDCORHE	NMHC	Carl
HEDCOR, Inc.	01NMHC_G01	HEDCORHE	NMHC	Carl
HEDCOR, Inc.	01AMPHAW_G01	HEDCORHE	AMPHAW	Carl
HEDCOR, Inc.	01BAKSIP_G01	HEDCORHE	BAKSIP	Carl
HEDCOR, Inc.	01BINENG_G01	HEDCORHE	BINENG	Carl
HEDCOR, Inc.	13TALOM1_G01	HEDCORHE	TALOM	Carl
HEDCOR, Inc.	13TALOM23_G01	HEDCORHE	TALOM23	Carl
Helios Solar Energy Corporation	06HELIOS_G01	HELIOSGEN	HELIOS	Super
HyperGreen Energy Corporation	01HYPGRN_G01	HGECGEN	HYPGRN	CF
Ingrid Power Holdings, Inc.	03INGRID_GS1	IPHI1GEN	INGRID	Carl
Ingrid Power Holdings, Inc.	03INGRID_GS2	IPHI1GEN	INGRID	Carl
Ingrid Power Holdings, Inc.	03INGRID_GS3	IPHI1GEN	INGRID	Carl
Ingrid Power Holdings, Inc.	03INGRID_GS4	IPHI1GEN	INGRID	Carl
Ingrid Power Holdings, Inc.	03INGRID_GS5	IPHI1GEN	INGRID	Carl
Ingrid Power Holdings, Inc.	03INGRID_GS6	IPHI1GEN	INGRID	Carl
Isabel Ancillary Services Co. Ltd.	04IASMOD_G01	IASCOGEN	IASMOD	Super
Isabel Ancillary Services Co. Ltd.	04IASMOD_G02	IASCOGEN	IASMOD	Super
Isabel Ancillary Services Co. Ltd.	04IASMOD_G03	IASCOGEN	IASMOD	Super
Isabel Ancillary Services Co. Ltd.	04IASMOD_G04	IASCOGEN	IASMOD	Super
Isabel Ancillary Services Co. Ltd.	04IASMOD_G05	IASCOGEN	IASMOD	Super
Isabel Ancillary Services Co. Ltd.	04IASMOD_G06	IASCOGEN	IASMOD	Super
Isabela Biomass Energy Corporation	01IBEC_G01	IBECGEN	IBEC	Super
Isabela La Suerte Rice Mill Corporation	01LASUER_U01	ILSRMCGEN	LASUER	Super
Jobin-SQM Inc.	01SUBSOL_G01	JOBINGEN	SUBSOL	Carl
KEPCO SPC Power Corporation	05KSPC_G01	KSPCGEN	KSPC	CF
KEPCO SPC Power Corporation	05KSPC_G02	KSPCGEN	KSPC	CF
King Energy Generation - Gingoog	12KEGGIN_G01	KINGENEGEN	KEGMIS	CF
King Energy Generation - Jimenez	09KEGJIM_G01	KINGENEGEN	KEGJIM	CF
King Energy Generation - Maramag	11KEGMAR_G01	KINGENEGEN	KEGMAR	CF
King Energy Generation - Tandag	12KEGTAN_G01	KINGENEGEN	KEGSUR	CF
King Energy Generation-Panaon	09KEGPN_G01	KINGENEGEN	KEGPN	CF
Kirahon Solar Energy Corporation	11KIRAS_G01	KIRASOLGEN	KIRAS	CF
Labayat 1 Hydropower Corporation	03UPLAB_G01	UPLAB1GEN	UPLAB	Super
Lamsan Power Corporation	14LAMSAN_G01	LAMSANGEN	LAMSAN	Carl
Maibarara Geothermal, Inc.	03MGPP_G01	MGIGEN	MGPP	Super
Maibarara Geothermal, Inc.	03MGI_G02	MGIGEN	MGI	Super
Majayjay Hydropower Company, Inc.	03MAJAY_G01	MHCIGEN	MAJAY	CF
Majestics Energy Corporation	03MEC_G01	MECGEN	MEC	CF
Mapalad Energy Generation Corporation	10MEGC_G01	MEGCGEN	MEGC	CF

Mapalad Partners, Inc. (DIGOS)	13MPCDIG_G01	MPIDIGOSGEN	MPCDIG	CF
Mapalad Power Corporation	10IDPP_G01	MPCGEN	IDPP	CF
Mariveles Power Generation Corporation	01MPGC_U01	MPGCGEN	MPGC	CF
Masinloc Power Partners Co. Ltd.	01MSINLO_G01	MPPCLGEN	MSINLO	Carl
Masinloc Power Partners Co. Ltd.	01MSINLO_G02	MPPCLGEN	MSINLO	Carl
Masinloc Power Partners Co. Ltd.	01MSINLO_G03	MPPCLGEN	MSINLO	Carl
Masinloc Power Partners Co. Ltd.	01MSINLO_BAT	MPPCLGEN	MSNLO	Carl
Mindanao Energy Systems - Cabulig	11MNCBLG_G01	MINERGYGEN	MNCBLG	Super
Mindanao Energy Systems - Sulzer	11MNRGY_G01	MINERGYGEN	MNRGY	Carl
Mindanao Energy Systems - Wartzila	11MNRGY_G02	MINERGYGEN	MNRGY	Carl
Mindoro Grid Corporation	01BUTAO_G01	MGCGEN	BUTAO	CF
Minergy Power Corporation	11MINBAL_G01	MINPOWCORGEN	MINBAL	CF
Mirae Asia Energy Corporation	01MAEC_G01	MAECGEN	MAEC	CF
Montalban Methane Power Corp.	02MMPP_G01	MMPC	MMPP	CF
Monte Solar Energy Inc.	06MNTSOL_G01	MONTESOLGEN	MNTSOL	Super
MORE Power Barge Inc.	08STBPB1_U01	MPBIGEN	STBAR1	Carl
MORE Power Barge Inc.	08STBPB1_U02	MPBIGEN	STBAR1	Carl
MORE Power Barge Inc.	08STBPB1_U03	MPBIGEN	STBAR1	Carl
MORE Power Barge Inc.	08STBPB1_U04	MPBIGEN	STBAR1	Carl
National Irrigation Administration	01NIABAL_G01	NIABAL	NIABAL	Carl
Negros Island Solar Power Inc.	06CARSOL_G01	NISPI	CARSOL	CF
Negros Island Solar Power Inc.	06MANSOL_G01	NISPI2	MANSOL	CF
Citicore Solar Bataan, Inc.	01MARSOL_G01	NEXTGEN	MARSOL	Super
Nickel Asia Corporation	12NACSUR_G01	NACSURGEN	NACSUR	Super
North Bukidnon Power Corp.	11NBPC_G01	NBPCGEN	NBPC	Super
North Luzon Renewable Energy Corporation	01CAPRIS_G01	NLRECGEN	CAPRIS	Carl
North Negros Biopower, Inc.	06NTNEGB_G01	NNBPGEN	NTNEGB	Super
North Wind Power Development Corporation	01NWIND_G01	NORTHWIND	NWIND	Super
North Wind Power Development Corporation	01NWIND_G02	NORTHWIND	NWIND	Super
Citicore Solar Tarlac 2 Inc.	01DALSOL_G01	NVVOGTDAL	DALSOL	Super
Nuevo Solar Energy Corp.	01CURSOL_G02	NSECGEN	CURSOL	Super
NV Vogt Philippines Solar Energy One Inc.	14NVSOL_G01	NVVOGTSE1GEN	NVSOL	Super
Citicore Solar Tarlac 1, Inc.	01ARMSOL_G01	NVVOGTARM	ARMSOL	Super
One Subic Power Generation Corporation	01S_ENRO_G01	OSPGCGEN	S-ENRO	Super
Oriental Energy & Power Generation Corp.	08TIMBA_G01	OEPGCGEN	TIMBA	Super
PACERM-1 Energy Corporation	11PACERM_G01	PACERM1GEN	PACERM	Super
Pagbilao Energy Corporation	03PAGBIL_G03	PECGEN	PAGBIL3	CF
Palm Concepcion Power Corporation	08PALM_G01	PCPCGEN	PALM	CF
Panasia Energy, Inc.	01LIMAY_U01	PANASIAGEN	LIMAY	CF
Panasia Energy, Inc.	01LIMAY_U02	PANASIAGEN	LIMAY	CF
Panasia Energy, Inc.	01LIMAY_U03	PANASIAGEN	LIMAY	CF
Panasia Energy, Inc.	01LIMAY_U04	PANASIAGEN	LIMAY	CF
Panasia Energy, Inc.	01LIMAY_U05	PANASIAGEN	LIMAY	CF
Panasia Energy, Inc.	01LIMAY_U06	PANASIAGEN	LIMAY	CF

Panasia Energy, Inc.	01LIMAY_U07	PANASIAGEN	LIMAY	CF
Panasia Energy, Inc.	01LIMAY_U08	PANASIAGEN	LIMAY	CF
Panay Energy Development Corporation	08PEDC_U01	PEDCGEN	PEDC	Super
Panay Energy Development Corporation	08PEDC_U02	PEDCGEN	PEDC	Super
Panay Energy Development Corporation	08PEDC_U03	PEDCGEN	PEDC	Super
Panay Power Corporation	08GLOBAL_G01	PPCGEN	GLOBAL	Super
Panay Power Corporation	08PPC1_A	PPCGEN	PPC	Super
Panay Power Corporation	08PPC1_B	PPCGEN	PPC	Super
Panay Power Corporation	08PPC_G02	PPCGEN	AVON	Super
Pangea Green Energy Philippines, Inc.	02PNGEA_G01	PGEP	PNGEA	CF
Peak Power San Francisco	12PKSFRA_U01	PEAKPOWERGEN	PKSFRA	Super
Peak Power San Francisco	12PKSFRA_U02	PEAKPOWERGEN	PKSFRA	Super
Peak Power Soccsargen, Inc.	14PKPSOC_G01	PSIGEN	PKPSOC	Super
Peakpower Bukidnon Inc.	11PKBUK_G01	PEAKBUKGEN	PKBUK	Super
People's Energy Services Inc.	03BART_G01	PESIGEN	BART	Super
Petron Corporation	01PETRON_G01	PETROGEN	PETRON	CF
PetroSolar Corporation	01PETSOL_G01	PETROSOLRGEN	PETSOL	Carl
PetroSolar Corporation	01PETSOL_G02	PETROSOLRGEN	PETSOL	Carl
PetroWind Energy Inc.	08PWIND_G01	PWEIGEN	PWIND	Carl
PH Renewables, Inc.	02PNGYSOL_G01	PHRIGEN	PNGYSOL	CF
Philippine Power and Development Company	03PALAK_G01	PPDCGEN	PALAK	CF
Philippine Power and Development Company	03BALUG_G01	PPDCGEN	BALUG	CF
Philippine Power and Development Company	03CLBATO_G01	PPDCGEN	CLBATO	CF
Power Sector Asset and Liabilities Management Corporation	10AGUS1_U01	PSALMGENM	AGUS1	Carl
Power Sector Asset and Liabilities Management Corporation	10AGUS1_U02	PSALMGENM	AGUS1	Carl
Power Sector Asset and Liabilities Management Corporation	10AGUS2_U01	PSALMGENM	AGUS2	Carl
Power Sector Asset and Liabilities Management Corporation	10AGUS2_U02	PSALMGENM	AGUS2	Carl
Power Sector Asset and Liabilities Management Corporation	10AGUS2_U03	PSALMGENM	AGUS2	Carl
Power Sector Asset and Liabilities Management Corporation	10AGUS4_U01	PSALMGENM	AGUS4	Carl
Power Sector Asset and Liabilities Management Corporation	10AGUS4_U02	PSALMGENM	AGUS4	Carl
Power Sector Asset and Liabilities Management Corporation	10AGUS4_U03	PSALMGENM	AGUS4	Carl
Power Sector Asset and Liabilities Management Corporation	10AGUS5_U01	PSALMGENM	AGUS5	Carl
Power Sector Asset and Liabilities Management Corporation	10AGUS5_U02	PSALMGENM	AGUS5	Carl
Power Sector Asset and Liabilities Management Corporation	10AGUS6_U01	PSALMGENM	AGUS6	Carl
Power Sector Asset and Liabilities Management Corporation	10AGUS6_U02	PSALMGENM	AGUS6	Carl
Power Sector Asset and Liabilities Management Corporation	10AGUS6_U03	PSALMGENM	AGUS6	Carl
Power Sector Asset and Liabilities Management Corporation	10AGUS6_U04	PSALMGENM	AGUS6	Carl

Power Sector Asset and Liabilities Management Corporation	10AGUS6_U05	PSALMGENM	AGUS6	Carl
Power Sector Asset and Liabilities Management Corporation	10AGUS7_U01	PSALMGENM	AGUS7	Carl
Power Sector Asset and Liabilities Management Corporation	10AGUS7_U02	PSALMGENM	AGUS7	Carl
Power Sector Asset and Liabilities Management Corporation	11PULA4_U01	PSALMGEN	PULA4	Super
Power Sector Asset and Liabilities Management Corporation	11PULA4_U02	PSALMGEN	PULA4	Carl
Power Sector Asset and Liabilities Management Corporation	11PULA4_U03	PSALMGEN	PULA4	Carl
Power Sector Asset and Liabilities Management Corporation	14MTAPO_U02	PSALMGEN	MTAPO	Carl
Power Sector Asset and Liabilities Management Corporation	11STEAG_U01	PSALMGEN	STEAG	Carl
Power Sector Asset and Liabilities Management Corporation	11STEAG_U02	PSALMGEN	STEAG	Carl
PowerSource Philippines Energy, Inc.	10PPEI_U01	PPEIGEN	PPEI	CF
Prime Meridian PowerGen Corporation	03AVION_U01	PMPCGEN	AVION	Carl
Prime Meridian PowerGen Corporation	03AVION_U02	PMPCGEN	AVION	Carl
Energy Development Corporation	04LEYTE_A	PSALMGEN	LEYTE	Carl
PSALM Corporation	01CASECN_G01	PSALMGEN	CASECN	CF
PSALM Corporation	03BOTOCA_G01	PSALMGEN	BOTOCA	CF
PSALM Corporation	03CALIRY_G01	PSALMGEN	CALIRY	CF
PSALM Corporation	03KAL_G01	PSALMGEN	KAL	Carl
PSALM Corporation	03KAL_G02	PSALMGEN	KAL	Carl
PSALM Corporation	03KAL_G03	PSALMGEN	KAL	Carl
PSALM Corporation	03KAL_G04	PSALMGEN	KAL	Carl
PSALM Corporation	03MALAYA_G01	PSALMGEN	MALAYA	Super
Quezon Power (Philippines) Ltd. Co.	03QPPL_G01	QPPLGEN	QPPL	CF
RASLAG Corp.	01RASLAG_G01	RCGEN	RASLAG	CF
RASLAG Corp.	01RASLAG_G02	RCGEN	RASLAG	CF
RASLAG Corp.	01RASLAG_G03	RCGEN	RASLAG	CF
Republic Cement & Building Materials, Inc.	03RCBMI_G01	RCBMIGEN	RCBMI	Super
Republic Cement & Building Materials, Inc.	03RCBMI_G02	RCBMIGEN	RCBMI	Super
San Buenaventura Power Ltd. Co.	03SBPL_G01	SBPLC	SBPL	CF
San Carlos Bioenergy, Inc.	06SCBE_G01	SCBIGEN	SCBE	Super
San Carlos Biopower, Inc.	06SCBIOP_G01	SCBIPOWRGEN	SCBIOP	Carl
San Carlos Solar Energy, Inc.	06SACASL_G01	SACASOLGEN	SACASL	Carl
San Carlos Solar Energy, Inc.	06SACASL_G02	SACASOLGEN	SACASL	Carl
San Carlos Sun Power, Inc.	06SACSUN_G01	SACASUNGEN	SACSUN	Carl
San Jose City I Power Corporation	01IPOWER_G01	IPOWERGEN	IPOWER	Super
San Jose City I Power Corporation	01IPOWER_G02	IPOWERGEN	IPOWER	Super
San Miguel Consolidated Power Corporation	13SMC_U01	SMCPCGEN	SMCPC	CF
San Miguel Consolidated Power Corporation	13SMC_U02	SMCPCGEN	SMCPC	CF
San Miguel Energy Corporation	01SUAL_G01	SMECGEN	SUAL	Carl
San Miguel Energy Corporation	01SUAL_G02	SMECGEN	SUAL	Carl
Sarangani Energy Corporation	14SARANG_U01	SECGEN	SARANG1	Carl

Sarangani Energy Corporation	14SARANG_U02	SECGEN	SARANG2	Carl
SEM-Calaca Power Corporation	03CALACA_G01	SCPCGEN	CALACA	CF
SEM-Calaca Power Corporation	03CALACA_G02	SCPCGEN	CALACA	CF
Citicore Solar Negros Occidental, Inc	06SLYSOL_G01	SILAYSPIGEN	SLYSOL	Super
Limay Power Inc.	01SMC_G01	SMCCPCGEN	SMC	Carl
Limay Power Inc.	01SMC_G02	SMCCPCGEN	SMC	Carl
Limay Power Inc.	01SMC_G03	SMCCPCGEN	SMC	Carl
Limay Power Inc.	01SMC_G04	SMCCPCGEN	SMC	Carl
SMCGP Philippines Energy Storage Co. Ltd.	06KABAN_BAT	SPESCLGEN	KABAN	CF
Smith Bell Mini-Hydro Corporation	01SMBELL_G01	SBMHCGEN	SMBELL	Super
SN Aboitiz Power - Benguet, Inc.	01BINGA_U01	SNAPBGEN	BINGA	CF
SN Aboitiz Power - Benguet, Inc.	01BINGA_U02	SNAPBGEN	BINGA	CF
SN Aboitiz Power - Benguet, Inc.	01BINGA_U03	SNAPBGEN	BINGA	CF
SN Aboitiz Power - Benguet, Inc.	01BINGA_U04	SNAPBGEN	BINGA	CF
SN Aboitiz Power - Benguet, Inc.	01AMBUK_U01	SNAPBGEN	AMBUK	Super
SN Aboitiz Power - Benguet, Inc.	01AMBUK_U02	SNAPBGEN	AMBUK	Super
SN Aboitiz Power - Benguet, Inc.	01AMBUK_U03	SNAPBGEN	AMBUK	Super
SN Aboitiz Power - Magat, Inc.	01MAGAT_U01	SNAPMGEN	MAGAT	Carl
SN Aboitiz Power - Magat, Inc.	01MAGAT_U02	SNAPMGEN	MAGAT	Carl
SN Aboitiz Power - Magat, Inc.	01MAGAT_U03	SNAPMGEN	MAGAT	Carl
SN Aboitiz Power - Magat, Inc.	01MAGAT_U04	SNAPMGEN	MAGAT	Carl
SN Aboitiz Power - Magat, Inc.	01MARIS_U01	SNAPMGEN	MARIS	Carl
SN Aboitiz Power - Magat, Inc.	01MARIS_U02	SNAPMGEN	MARIS	Carl
SN Aboitiz Power - Magat, Inc.	01MAGAT_BAT	SNAPMGEN	MAGAT	Carl
Solar Philippines Calatagan Corporation	03CALSOL_G01	SOLARPHILGEN	CALSOL	Super
Solar Philippines Commercial Rooftop Projects, Inc.	02SMNRTH_G01	SPSMNORTH	SMNRTH	Super
Solar Philippines Tarlac Corporation	01CONSOL_G01	SOLARPHTCGEN	CONSOL	Super
SOLARACE1 Energy Corp.	03SOLACE_G01	SOLARACE1GEN	SOLACE	Carl
South Luzon Thermal Energy Corporation	03SLTEC_G01	SLTECGEN	SLTEC	Super
South Luzon Thermal Energy Corporation	03SLTEC_G02	SLTECGEN	SLTEC	Super
South Negros Biopower, Inc.	06STNEGB_G01	SNBPGEN	STNEGB	Carl
South Premiere Power Corporation	03ILIJAN_G01	SPPCGEN	ILIJAN	Carl
South Premiere Power Corporation	03ILIJAN_G02	SPPCGEN	ILIJAN	Carl
Southwest Luzon Power Generation Corporation	03SLPGC_G01	SLPGCGEN	SLPGCC	Super
Southwest Luzon Power Generation Corporation	03SLPGC_G02	SLPGCGEN	SLPGCC	Super
SPARC-Solar Powered Agri-Rural Communities Corporation	01ZAMSOL_G01	SPARCGEN	ZAMSOL	Super
SPARC-Solar Powered Agri-Rural Communities Corporation	01BTNSOL_G01	SPARCGEN	BTNSOL	Super
SPARC-Solar Powered Agri-Rural Communities Corporation	01SPABUL_G01	SPARCGEN	SPABUL	Super
SPC Island Power Corporation	07BDPP_U01	SIPCGEN	BDPP	CF
SPC Island Power Corporation	07BDPP_U02	SIPCGEN	BDPP	CF
SPC Island Power Corporation	07BDPP_U03	SIPCGEN	BDPP	CF
SPC Island Power Corporation	07BDPP_U04	SIPCGEN	BDPP	CF

SPC Island Power Corporation	08PDPP1_U02	SIPCGEN	PDPP	CF
SPC Island Power Corporation	08PDPP1_U03	SIPCGEN	PDPP	CF
SPC Island Power Corporation	08PDPP1_U05	SIPCGEN	PDPP	CF
SPC Island Power Corporation	08PDPP3_C	SIPCGEN	PDPP3	CF
SPC Island Power Corporation	08PDPP3_E	SIPCGEN	PDPP3	CF
SPC Island Power Corporation	08PDPP3_G	SIPCGEN	PDPP3	CF
SPC Island Power Corporation	08PDPP3_H	SIPCGEN	PDPP3	CF
SPC Power Corporation	07TPLPB4_U01	SPCGEN	TAPAL	CF
SPC Power Corporation	07TPLPB4_U02	SPCGEN	TAPAL	CF
SPC Power Corporation	07TPLPB4_U03	SPCGEN	TAPAL	CF
SPC Power Corporation	07TPLPB4_U04	SPCGEN	TAPAL	CF
Sta Clara Power Corporation	07LOBOC_G01	STACLARAGEN	LOBOC	CF
Sta Clara Power Corporation	07LOBOC_G02	STACLARAGEN	LOBOC	CF
Strategic Energy Development Inc.	13MAGDBNK_G01	SEDIGEN	MAGDBNK	Carl
Strategic Power Development Corporation	01SROQUE_U01	SPDCGEN	SROQUE	CF
Strategic Power Development Corporation	01SROQUE_U02	SPDCGEN	SROQUE	CF
Strategic Power Development Corporation	01SROQUE_U03	SPDCGEN	SROQUE	CF
Sulu Electric Power and Light (Phils.), Inc.	04SEPSOL_G01	SEPALCOGEN	SEPSOL	CF
Supreme Power Corporation	13MATIBNK_G01	SUPREMEPCGEN	MATIBNK	Super
Sunwest Water and Electric Company 2, Inc.	08SUWECO_G01	SUWECO2GEN	SUWECO	Super
Supreme Power Corporation	14SUPKOR_G01	SUPREMEPCGEN	SUPKOR	Super
Surallah Power Generation Inc.	14SPGI_U01	SPGIGEN	SPGI	Super
Taft Hydroenergy Corporation	04TAFT_G01	TAFTHECGEN	TAFT	Carl
Terasu Energy Inc.	01TERASU_G01	TERASUGEN	TERASU	Carl
Tibag Hydropower Corporation	03TIBAG_G01	THCGEN	TIBAG	Super
Therma Luzon, Inc.	03PAGBIL_G01	TLIGEN	PAGBIL	Super
Therma Luzon, Inc.	03PAGBIL_G02	TLIGEN	PAGBIL	Super
Therma Marine, Inc.	12TM2_U01	TMIGEN	TM2	Super
Therma Marine, Inc.	12TM2_U02	TMIGEN	TM2	Super
Therma Marine, Inc.	13TM1_U01	TMIGEN	TM1	Super
Therma Marine, Inc.	13TM1_U02	TMIGEN	TM1	Super
Therma Mobile, Inc.	02TMOBIL_G01	TMOGEN	TMO	CF
Therma Mobile, Inc.	02TMOBIL_G02	TMOGEN	TMO	CF
Therma Mobile, Inc.	02TMOBIL_G03	TMOGEN	TMO	CF
Therma Mobile, Inc.	02TMOBIL_G04	TMOGEN	TMO	CF
Therma Power Visayas, Inc.	05TPVI_U01	TPVIGEN	TPVI	Carl
Therma Power Visayas, Inc.	05TPVI_U02	TPVIGEN	TPVI	Carl
Therma Power Visayas, Inc.	05TPVI_U03	TPVIGEN	TPVI	Carl
Therma Power Visayas, Inc.	05TPVI_U04	TPVIGEN	TPVI	Carl
Therma Power Visayas, Inc.	05TPVI_U05	TPVIGEN	TPVI	Carl
Therma Power Visayas, Inc.	05TPVI_U06	TPVIGEN	TPVI	Carl
Therma South, Inc.	13DCPP_U01	TSIGEN	DCPP	CF
Therma South, Inc.	13DCPP_U02	TSIGEN	DCPP	CF
Therma Visayas, Inc.	05THVI_U01	TVIGEN	THVI	Super
Therma Visayas, Inc.	05THVI_U02	TVIGEN	THVI	Super

Toledo Power Company	05TPC_G02	TPCGEN	SANGI	Super
Toledo Power Company	05TPC_G01	TPCGEN	CARMEN	Super
United Pulp and Paper Company, Inc.	01UPPC_G01	UPPCGEN	UPPC	Super
Universal Power Solutions, Inc	01CNCEP_BAT	UPSIGEN	CNCEP	Super
Universal Power Solutions, Inc	13MALITA_BAT	UPSIGEN	MALITAB	Super
Universal Power Solutions, Inc	13MACO_BAT	UPSIGEN	MACO	Super
Universal Power Solutions, Inc	11JASA_BAT	UPSIGEN	JASA	Super
Universal Power Solutions, Inc	11VILLA_BAT	UPSIGEN	VILLA	Super
Agusan Power Corporation	12LKMAINIT_G01	APCGEN	LMAINIT	Super
Universal Power Solutions, Inc.	01LAMAO_BAT	UPSIGEN	LAMAOB	CF
Universal Power Solutions, Inc.	01LIMAY_BAT	UPSIGEN	LIMAYB	CF
Universal Power Solutions, Inc.	05TOLEDO_BAT	UPSIGEN	TOLEDOB	CF
Universal Power Solutions, Inc.	07UBAY_BAT	UPSIGEN	UBAYB	CF
Universal Power Solutions, Inc.	01SNMAN_BAT	UPSIGEN	SNMAN	CF
Universal Power Solutions, Inc.	01MAGAPIT_BAT	UPSIGEN	MAGAPIT	Carl
Universal Power Solutions, Inc.	04ORMOC_BAT	UPSIGEN	ORMOC	Carl
Universal Robina Corporation	06URC_G01	URCGEN	URC	Super
Valenzuela Solar Energy, Inc.	02VALSOL_G01	VSEIGEN	VALSOL	Carl
Victorias Milling Company, Inc.	06VMC_G01	VMCGEN	VMC	CF
Victorias Milling Company, Inc.	06VMC_G02	VMCGEN	VMC2	CF
Northern Renewables Generation Corporation	01BAKUN_G01	NRGEN	BAKUN	Super
VS Gripal Power Corporation	01VSGRIP_G01	VSGPCGEN	VSGRIP	Super
Western Mindanao Power Corporation	09WMPC_U01	WMPCGEN	WMPC	CF
Western Mindanao Power Corporation	09WMPC_U02	WMPCGEN	WMPC	CF
Western Mindanao Power Corporation	09WMPC_U03	WMPCGEN	WMPC	CF
Western Mindanao Power Corporation	09WMPC_U04	WMPCGEN	WMPC	CF
Western Mindanao Power Corporation	09WMPC_U05	WMPCGEN	WMPC	CF
Western Mindanao Power Corporation	09WMPC_U06	WMPCGEN	WMPC	CF
Western Mindanao Power Corporation	09WMPC_U07	WMPCGEN	WMPC	CF
Western Mindanao Power Corporation	09WMPC_U08	WMPCGEN	WMPC	CF
Western Mindanao Power Corporation	09WMPC_U09	WMPCGEN	WMPC	CF
Western Mindanao Power Corporation	09WMPC_U10	WMPCGEN	WMPC	CF
YH Green Energy, Incorporated	01YHGRN_G01	YHGEIGEN	YHGRN	Carl